



1006



Bogen aus Edelstahl V4A, **beiderseits
 Außengewinde**

| <u>Artikelbezeichnung</u> | <u>Größe</u> | <u>Artikel-Nr.</u> | <u>Warengruppe</u> |
|---|--------------|--------------------|--------------------|
| Bogen aus Edelstahl V4A, beiderseits Außengewinde | 1/4" | 100602 | B/A06.01 |
| | 3/8" | 100603 | |
| | 1/2" | 100604 | |
| | 3/4" | 100605 | |
| | 1" | 100606 | |
| | 1 1/4" | 100607 | |
| | 1 1/2" | 100608 | |
| | 2" | 100609 | |

1021

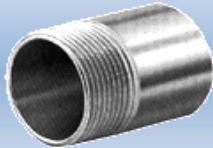

Anschweißnippel aus Edelstahl V4A, **einseitig
 Außengewinde**

| | | | |
|---|--------|--------|----------|
| Anschweißnippel aus Edelstahl V4A, einseitig Außengewinde | 1/4" | 102102 | B/A06.01 |
| | 3/8" | 102103 | |
| | 1/2" | 102104 | |
| | 3/4" | 102105 | |
| | 1" | 102106 | |
| | 1 1/4" | 102107 | |
| | 1 1/2" | 102108 | |
| | 2" | 102109 | |
| | 2 1/2" | 102110 | |

1022

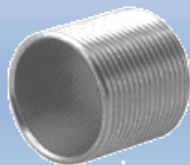

Rohnippel glatt aus Edelstahl V4A,
durchgehendes Gewinde

| | | | |
|--|--------------|------------|----------|
| Rohnippel glatt aus Edelstahl V4A, durchgehendes Gewinde | 1/8"x016mm | 1022010016 | B/A06.02 |
| | 1/4"x018mm | 1022020018 | |
| | 1/4"x100mm | 1022020100 | |
| | 3/8"x025mm | 1022030025 | |
| | 3/8"x100mm | 1022030100 | |
| | 1/2"x025mm | 1022040025 | |
| | 1/2"x100mm | 1022040100 | |
| | 3/4"x030mm | 1022050030 | |
| | 3/4"x100mm | 1022050100 | |
| | 1"x035mm | 1022060035 | |
| | 1"x100mm | 1022060100 | |
| | 1 1/4"x038mm | 1022070038 | |
| 1 1/4"x100mm | 1022070100 | | |



1022

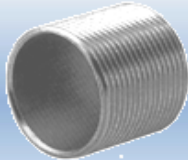

Rohrnippel glatt aus Edelstahl V4A,
durchgehendes Gewinde

| Größe | Artikel-Nr. |
|--------------|-------------|
| 1 1/2"x038mm | 1022080038 |
| 1 1/2"x100mm | 1022080100 |
| 2"x045mm | 1022090045 |
| 2"x100mm | 1022090100 |
| 2 1/2"x055mm | 1022100055 |

B/A06.02

1023

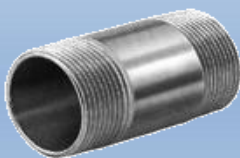

Rohrdoppelnippel aus Edelstahl V4A, **beiderseits
Außengewinde**

| | |
|------------|-----------|
| 1/8"x030mm | 102301030 |
| 1/4"x030mm | 102302030 |
| 1/4"x040mm | 102302040 |
| 1/4"x060mm | 102302060 |
| 1/4"x100mm | 102302100 |
| 1/4"x150mm | 102302150 |
| 1/4"x250mm | 102302250 |
| 3/8"x040mm | 102303040 |
| 3/8"x100mm | 102303100 |
| 3/8"x150mm | 102303150 |
| 1/2"x060mm | 102304060 |
| 1/2"x080mm | 102304080 |
| 1/2"x100mm | 102304100 |
| 1/2"x150mm | 102304150 |
| 1/2"x200mm | 102304200 |
| 1/2"x250mm | 102304250 |
| 1/2"x300mm | 102304300 |
| 3/4"x060mm | 102305060 |
| 3/4"x080mm | 102305080 |
| 3/4"x100mm | 102305100 |
| 3/4"x150mm | 102305100 |
| 3/4"x200mm | 102305200 |
| 1"x060mm | 102306060 |
| 1"x080mm | 102306080 |
| 1"x100mm | 102306100 |
| 1"x150mm | 102306150 |
| 1"x200mm | 102306200 |
| 1"x300mm | 102306300 |

B/A06.03



Artikelbezeichnung

Größe

Artikel-Nr.

Warengruppe



Rohrdoppelnippel aus Edelstahl V4A, **beiderseits Außengewinde**

| | |
|--------------|-----------|
| 11/4"x080mm | 102307080 |
| 11/4"x150mm | 102307150 |
| 11/4"x200mm | 102307200 |
| 11/2"x080mm | 102308080 |
| 11/2"x150mm | 102308150 |
| 11/2"x200mm | 102308200 |
| 2"x100mm | 102309100 |
| 2"x150mm | 102309150 |
| 2"x200mm | 102309200 |
| 2 1/2"x100mm | 102310100 |
| 3"x120mm | 102311120 |
| 4"x150mm | 102312150 |

B/A06.03

1090



Winkel 90° aus Edelstahl, **beiderseits Innengewinde**

| | |
|--------|--------|
| 1/8" | 109001 |
| 1/4" | 109002 |
| 3/8" | 109003 |
| 1/2" | 109004 |
| 3/4" | 109005 |
| 1" | 109006 |
| 1 1/4" | 109007 |
| 1 1/2" | 109008 |
| 2" | 109009 |
| 2 1/2" | 109010 |

B/A06.01

1092





Winkel 90° aus Edelstahl, **Innen-/Außengewinde**

| | |
|--------|--------|
| 1/8" | 109201 |
| 1/4" | 109202 |
| 3/8" | 109203 |
| 1/2" | 109204 |
| 3/4" | 109205 |
| 1" | 109206 |
| 1 1/4" | 109207 |
| 1 1/2" | 109208 |
| 2" | 109209 |
| 3" | 109211 |

B/A06.01

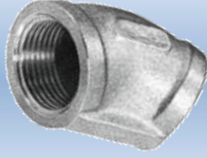

| | <u>Artikelbezeichnung</u> | <u>Größe</u> | <u>Artikel-Nr.</u> | <u>Warengruppe</u> |
|-------------|--|----------------|--------------------|--------------------|
| 1120 |  Winkel 45° aus Edelstahl, beiderseits Innengewinde | 1/4" | 112002 | B/A06.01 |
| | | 3/8" | 112003 | |
| | | 1/2" | 112004 | |
| | | 3/4" | 112005 | |
| | | 1" | 112006 | |
| | | 1 1/4" | 112007 | |
| | | 1 1/2" | 112008 | |
| | | 2" | 112009 | |
| 1130 |  T-Stück aus Edelstahl, allseitig Innengewinde | 1/8" | 113001 | B/A06.01 |
| | | 1/4" | 113002 | |
| | | 3/8" | 113003 | |
| | | 1/2" | 113004 | |
| | | 1/2"x3/8"x1/2" | 1130R040304 | |
| | | 3/4" | 113005 | |
| | | 3/4"x3/8"x3/4" | 1130R050305 | |
| | | 3/4"x1/2"x3/4" | 1130R050405 | |
| | | 1" | 113006 | |
| | | 1 1/4" | 113007 | |
| 1 1/2" | 113008 | | | |
| 2" | 113009 | | | |
| 1180 |  Kreuzstück aus Edelstahl, allseitig Innengewinde | 1/4" | 118002 | B/A06.01 |
| | | 3/8" | 118003 | |
| | | 1/2" | 118004 | |
| | | 3/4" | 118005 | |
| | | 1" | 118006 | |
| | | 1 1/4" | 118007 | |



Artikelbezeichnung

Größe

Artikel-Nr.

Warengruppe

1240

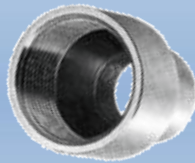

Reduziermuffe aus Edelstahl, **beiderseits
Innengewinde**

| | |
|---------------|----------|
| 1/4"x1/8" | 12400201 |
| 3/8"x1/4" | 12400302 |
| 1/2"x1/4" | 12400402 |
| 1/2"x3/8" | 12400403 |
| 3/4"x3/8" | 12400503 |
| 3/4"x1/2" | 12400504 |
| 1"x3/8" | 12400603 |
| 1"x1/2" | 12400604 |
| 1"x3/4" | 12400605 |
| 1 1/4"x1/2" | 12400704 |
| 1 1/4"x3/4" | 12400705 |
| 1 1/4"x1" | 12400706 |
| 1 1/2"x3/4" | 12400805 |
| 1 1/4"x1" | 12400806 |
| 1 1/4"x1 1/4" | 12400807 |
| 2"x1" | 12400906 |
| 2"x1 1/4" | 12400907 |
| 2"x1 1/2" | 12400908 |
| 2 1/2"x1 1/2" | 12401008 |
| 2 1/2"x2" | 12401009 |

B/A06.01

1241

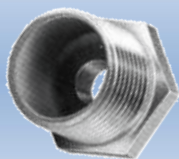

Reduzierstück aus Edelstahl, **Außen-
/Innengewinde**

| | |
|-----------|----------|
| 1/4"x1/8" | 12410201 |
| 3/8"x1/8" | 12410301 |
| 3/8"x1/4" | 12410302 |
| 1/2"x1/8" | 12410401 |
| 1/2"x1/4" | 12410402 |
| 1/2"x3/8" | 12410403 |
| 3/4"x1/4" | 12410502 |
| 3/4"x3/8" | 12410503 |
| 3/4"x1/2" | 12410504 |

B/A06.01



Artikelbezeichnung

Größe

Artikel-Nr.

Warengruppe

1241

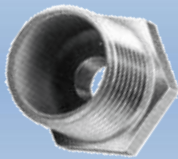

Reduzierstück aus Edelstahl, **Außen-
/Innengewinde**

| | |
|---------------|----------|
| 1"x1/4" | 12410602 |
| 1"x3/8" | 12410603 |
| 1"x1/2" | 12410604 |
| 1"x3/4" | 12410605 |
| 1 1/4"x1/2" | 12410704 |
| 1 1/4"x3/4" | 12410705 |
| 1 1/4"x1" | 12410706 |
| 1 1/2"x1/2" | 12410804 |
| 1 1/2"x3/4" | 12410805 |
| 1 1/2"x1" | 12410806 |
| 1 1/2"x1 1/4" | 12410807 |
| 2"x3/4" | 12410905 |
| 2"x1" | 12410906 |
| 2"x1 1/4" | 12410907 |
| 2"x1 1/2" | 12410909 |
| 2 1/2"x2" | 12411009 |
| 3"x1 1/2" | 12411108 |
| 3"x2" | 12411109 |
| 3"x2 1/2" | 12411110 |

B/A06.01

1245

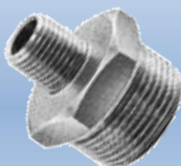

Doppelnippel aus Edelstahl, **reduziert, beiderseits
Außengewinde**

| | |
|---------------|----------|
| 1/4"x1/8" | 12450201 |
| 3/8"x1/4" | 12450302 |
| 1/2"x1/4" | 12450402 |
| 1/2"x3/8" | 12450403 |
| 3/4"x3/8" | 12450503 |
| 3/4"x1/2" | 12450504 |
| 1"x1/2" | 12450604 |
| 1"x3/4" | 12450606 |
| 1 1/4"x1" | 12450706 |
| 1 1/2"x1" | 12450806 |
| 1 1/2"x1 1/4" | 12450807 |
| 2"x1 1/2" | 12450908 |
| 3"x2" | 12451109 |

B/A06.01



1270

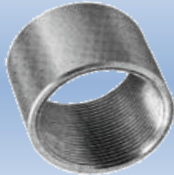

Muffe aus Edelstahl, **beiderseits Innengewinde**

| <u>Artikelbezeichnung</u> | <u>Größe</u> | <u>Artikel-Nr.</u> | <u>Warengruppe</u> |
|--|--------------|--------------------|--------------------|
| Muffe aus Edelstahl, beiderseits Innengewinde | 1/8" | 127001 | B/A06.01 |
| | 1/4" | 127002 | |
| | 3/8" | 127003 | |
| | 1/2" | 127004 | |
| | 3/4" | 127005 | |
| | 1" | 127006 | |
| | 1 1/4" | 127007 | |
| | 1 1/2" | 127008 | |
| | 2" | 127009 | |
| | 2 1/2" | 127010 | |
| | 3" | 127011 | |
| | 4" | 127012 | |

1275

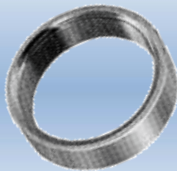

Halbe Muffe aus Edelstahl, **beiderseits Innengewinde**

| | | | |
|--|--------|--------|----------|
| Halbe Muffe aus Edelstahl, beiderseits Innengewinde | 1/8" | 127501 | B/A06.01 |
| | 1/4" | 127502 | |
| | 3/8" | 127503 | |
| | 1/2" | 127504 | |
| | 3/4" | 127505 | |
| | 1" | 127506 | |
| | 1 1/4" | 127507 | |
| | 1 1/2" | 127508 | |
| | 2" | 127509 | |

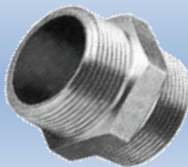

1280



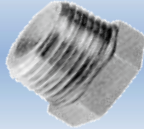
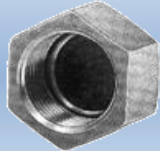
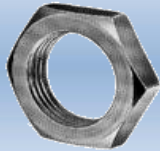

Doppelnippel aus Edelstahl, **beiderseits Außengewinde**

| | | | |
|---|--------|--------|----------|
| Doppelnippel aus Edelstahl, beiderseits Außengewinde | 1/8" | 128001 | B/A06.01 |
| | 1/4" | 128002 | |
| | 3/8" | 128003 | |
| | 1/2" | 128004 | |
| | 3/4" | 128005 | |
| | 1" | 128006 | |
| | 1 1/4" | 128007 | |
| | 1 1/2" | 128008 | |
| | 2" | 128009 | |
| | 2 1/2" | 128010 | |
| | 3" | 128011 | |





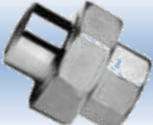

| | <u>Artikelbezeichnung</u> | <u>Größe</u> | <u>Artikel-Nr.</u> | <u>Warengruppe</u> |
|-------------|---|--------------|--------------------|--------------------|
| <u>1290</u> |  Stopfen aus Edelstahl, 6-Kant, Außengewinde | 1" | 129006 | B/A06.01 |
| | | 1 1/4" | 129007 | |
| | | 1 1/2" | 129008 | |
| | | 2" | 129009 | |
| | | 2 1/2" | 129010 | |
| | | 3" | 129011 | |
| <u>1300</u> |  Kappe aus Edelstahl, Innengewinde | 1/8" | 130001 | B/A06.01 |
| | | 1/4" | 130002 | |
| | | 3/8" | 130003 | |
| | | 1/2" | 130004 | |
| | | 3/4" | 130005 | |
| | | 1" | 130006 | |
| | | 1 1/4" | 130007 | |
| | | 1 1/2" | 130008 | |
| | | 2" | 130009 | |
| | | 2 1/2" | 130010 | |
| | | 3" | 130011 | |
| <u>1310</u> |  Kontermutter aus Edelstahl | 1/8" | 131001 | B/A06.01 |
| | | 1/4" | 131002 | |
| | | 3/8" | 131003 | |
| | | 1/2" | 131004 | |
| | | 3/4" | 131005 | |
| | | 1" | 131006 | |
| | | 1 1/4" | 131007 | |
| | | 1 1/2" | 131008 | |
| | | 2" | 131009 | |
| <u>1330</u> |  Verschraubung aus Edelstahl, Gußausführung, beiderseits Innengewinde, flachdichtend | 1/4" | 1330G02 | B/A06.01 |
| | | 3/8" | 1330G03 | |
| | | 1/2" | 1330G04 | |
| | | 3/4" | 1330G05 | |
| | | 1" | 1330G06 | |
| | | 1 1/4" | 1330G07 | |
| | | 1 1/2" | 1330G08 | |
| | | 2" | 1330G09 | |

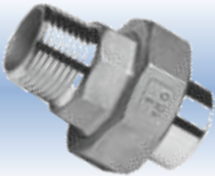

| | <u>Artikelbezeichnung</u> | <u>Größe</u> | <u>Artikel-Nr.</u> | <u>Warengruppe</u> |
|--------------|---|-----------------------------------|--|--------------------|
| <u>1331</u> |  Verschraubung aus Edelstahl, Innen-/Außengewinde , flachdichtend | 1/4" | 133102 | B/A06.01 |
| | | 3/8" | 133103 | |
| | | 1/2" | 133104 | |
| | | 3/4" | 133105 | |
| | | 1" | 133106 | |
| | | 1 1/4" | 133107 | |
| | | 1 1/2" | 133108 | |
| | | 2" | 133109 | |
| <u>1340L</u> |  Verschraubung aus Edelstahl, leichte Ausführung, beiderseits Innengewinde , konischdichtend | 1/4" | 1340L02 | B/A06.01 |
| | | 3/8" | 1340L03 | |
| | | 1/2" | 1340L04 | |
| | | 3/4" | 1340L05 | |
| | | 1" | 1340L06 | |
| | | 1 1/4" | 1340L07 | |
| | | 1 1/2" | 1340L08 | |
| | | 2" | 1340L09 | |
| 2 1/2" | 1340L10 | | | |
| <u>1341L</u> |  Verschraubung aus Edelstahl, leichte Ausführung, Innen-/ Außengewinde , konischdichtend | 1/4" | 1341L02 | B/A06.01 |
| | | 3/8" | 1341L03 | |
| | | 1/2" | 1341L04 | |
| | | 3/4" | 1341L05 | |
| | | 1" | 1341L06 | |
| | | 1 1/4" | 1341L07 | |
| | | 1 1/2" | 1341L08 | |
| | | 2" | 1341L09 | |
| 2 1/2" | 1341L10 | | | |
| <u>1342L</u> |  Verschraubung aus Edelstahl, einseitig Innengewinde, einseitig Schweißende , konischdichtend | 1/2"x21,3 3/4"x26,9 1"x33,7 | 1342L04213 1342L05269 1342L06337 | B/B02.05 |

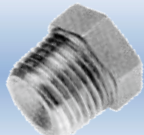

| | <u>Artikelbezeichnung</u> | <u>Größe</u> | <u>Artikel-Nr.</u> | <u>Warengruppe</u> |
|--------------|---|--|--|--------------------|
| <u>1343L</u> |  <p>Verschraubung aus Edelstahl, einseitig Außengewinde, einseitig Schweißende, konischdichtend</p> | 3/8"x17,2 1/2"x21,3 3/4"x26,9 1"x33,7 1 1/4"x42,4 1 1/2"x48,3 | 1343L03172 1343L04213 1343L05269 1343L06337 1343L07424 1343L08483 | B/B02.05 |
| <u>1333L</u> |  <p>Verschraubung aus Edelstahl, einseitig Außengewinde, einseitig Schweißende, flachdichtend</p> | 3/4"x26,9 1"x33,7 | 1333L05269 1333L06337 | B/B02.05 |
| <u>1095</u> |  <p>Winkel-Verschraubung aus Edelstahl, beiderseits Innengewinde, flachdichtend</p> | 3/4" | 109505 | B/A06.01 |
| <u>1097</u> |  <p>Winkel-Verschraubung aus Edelstahl, Innen-/Außengewinde, flachdichtend</p> | 3/4" | 109705 | B/A06.01 |
| <u>1098</u> |  <p>Winkel-Verschraubung aus Edelstahl, beiderseits Innengewinde, konischdichtend</p> | 3/4" | 109805 | B/A06.01 |
| <u>1910</u> |  <p>Stopfen aus Edelstahl, DIN 910</p> | 1/8" 1/4" 3/8" 1/2" 3/4" | 191001 191002 191003 191004 191005 | B/A06.01 |



Artikelbezeichnung

Größe

Artikel-Nr.

Warengruppe

1896



Schlauchtülle aus Edelstahl **V4A**, mit **konischem Außengewinde**, 6-Kant Schlüsselansatz

| | |
|---------------|----------|
| 1/8" x 07mm | 18960107 |
| 1/4" x 08mm | 18960208 |
| 1/4" x 09mm | 18960209 |
| 1/4" x 11mm | 18960211 |
| 3/8" x 09mm | 18960309 |
| 3/8" x 10mm | 18960310 |
| 3/8" x 11mm | 18960311 |
| 3/8" x 13mm | 18960313 |
| 1/2" x 09mm | 18960409 |
| 1/2" x 13mm | 18960413 |
| 1/2" x 15mm | 18960415 |
| 1/2" x 20mm | 18960420 |
| 3/4" x 19mm | 18960519 |
| 1" x 25mm | 18960625 |
| 1 1/4" x 32mm | 18960732 |
| 1 1/2" x 38mm | 18960838 |
| 2" x 50mm | 18960950 |
| 2 1/2" x 63mm | 18961063 |

F/C02.01

1020

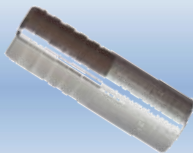

Anschweiß-Schlauchnippel aus Edelstahl V4A,
1.4571

| | |
|-----------------|-----------|
| 17,2mm (3/8") | 1020017.2 |
| 21,3mm (1/2") | 1020021.3 |
| 26,9mm (3/4") | 1020026.9 |
| 33,7mm (1") | 1020033.7 |
| 42,4mm (1 1/4") | 1020042.4 |
| 48,3mm (1 1/2") | 1020048.3 |
| 60,3mm (2") | 1020060.3 |

F/C02.02



Artikelbezeichnung

Größe

Artikel-Nr.

Warengruppe

V4A Reduzier-/Erweiterungsstutzen mit Innen-/
 Außengewinde, **1.4571**



VARI

AG1/8"xIG1/4" VARI0102
 AG1/8"xIG3/8" VARI0103

AG1/4"xIG3/8" VARI0203
 AG1/4"xIG1/2" VARI0204
 AG1/4"xIG3/4" VARI0205

AG3/8"xIG1/2" VARI0304
 AG3/8"xIG3/4" VARI0305

AG1/2"xIG3/4" VARI0405
 AG1/2"xIG1" VARI0406
 AG1/2"xIG1 1/4" VARI0407

B/D04.01

Auch in NPT-Ausführung:

AG1/8"xIG1/8"NPT VARI01G01NPT
 AG1/4"xIG1/4"NPT VARI02G02NPT
 AG1/4"NPTxIG1/4" VARI02NPT02G
 AG3/8"xIG3/8"NPT VARI03G03NPT
 AG3/8"NPTxIG3/8" VARI03NPT03G